

Lock case 5016 - Narrow Profile Cylinder Lock case

TO ORDER you must specify:

- lock case number
- direction of opening, i.e. right or left
- size of backset, i.e. 25 or 35 mm

Application:

- for narrow profile doors
- suitable for wood, steel or aluminium doors
- antifriction latch bolt and dead bolt

Operation:

- dead bolt operated by key or thumb turn
- antifriction latch bolt prevents vibrating
- double cylinder can be fitted

Materials and Finish:

- lock case - steel/chrome
- striker plate - steel/chrome
- 8 mm handle hub
- weighs 620 g

Delivery:

- available with 2 backsets: 25 or 35 mm
- includes striker plate
- includes cylinder fastening screws
- accessories must be ordered separately



Lock case 5016

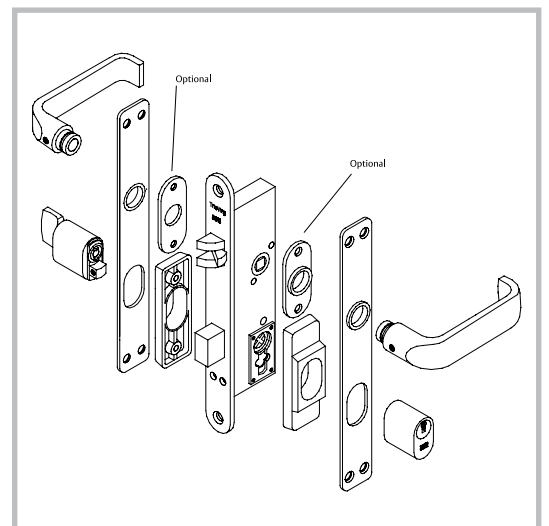

Lock case with available accessories

Lock case 5018 - Narrow Profile Dead Bolt Cylinder Lock case

TO ORDER you must specify:

- lock case number
- size of backset, i.e. 25 or 35 mm

Application:

- for narrow profile doors
- suitable for wood, steel or aluminium doors
- dead bolt function only

Operation:

- dead bolt operated by key or thumb turn
- double cylinder can be fitted

Materials and Finish:

- lock case - steel/chrome
- striker plate - steel/chrome
- weighs 560 g

Delivery:

- available with 2 backsets: 25 or 35 mm
- includes striker plate
- includes cylinder fastening screws
- accessories must be ordered separately



Lock case 5018

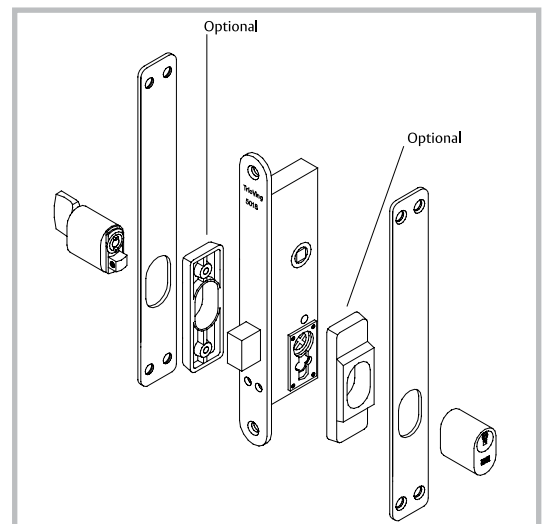

Lock case with available accessories

Lock case 5032 - Narrow Profile Cylinder Lock case

TO ORDER you must specify:

- lock case number
- direction of opening, i.e. right or left
- size of backset, i.e. 25 or 35 mm

Application:

- for narrow profile doors
- suitable for wood, steel or aluminium doors
- recommended in combination with door closer and electric striker plate

Operation:

- automatic dead latching (this function can be removed)
- if the door is unlocked at certain times, the security bolt is locked into the lock case and held in place by the snib

Materials and Finish:

- lock case - steel/chrome
- striker plate - steel/chrome
- weighs 560 g

Delivery:

- available with 2 backsets: 25 or 35 mm
- includes striker plate
- includes cylinder fastening screws
- accessories must be ordered separately



Lock case 5032

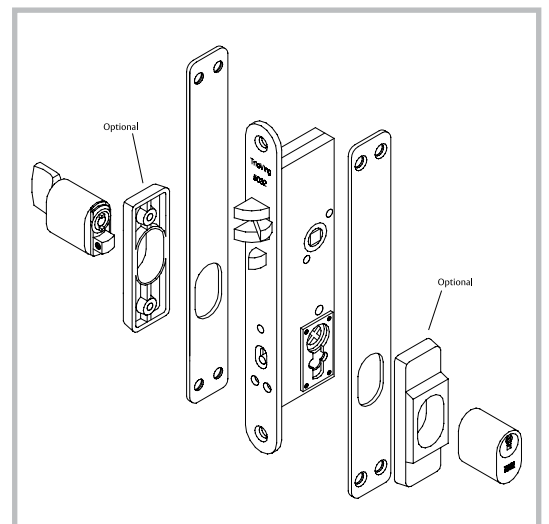

Lock case with available accessories

Lock case 5049 - Narrow Profile Cylinder Lock case with Hook

TO ORDER you must specify:

- lock case number
- size of backset, i.e. 25 or 35 mm

Application:

- for narrow profile doors
- suitable for wood, steel or aluminium doors
- suitable for sliding doors

Operation:

- the hook bolt is operated by key or thumb turn

Materials and Finish:

- lock case - steel/chrome
- striker plate - steel/chrome
- hook bolt - tempered steel core
- weighs 760 g

Delivery:

- available with 2 backsets: 25 or 35 mm
- includes striker plate
- includes cylinder fastening screws
- accessories must be ordered separately



Lock case 5049

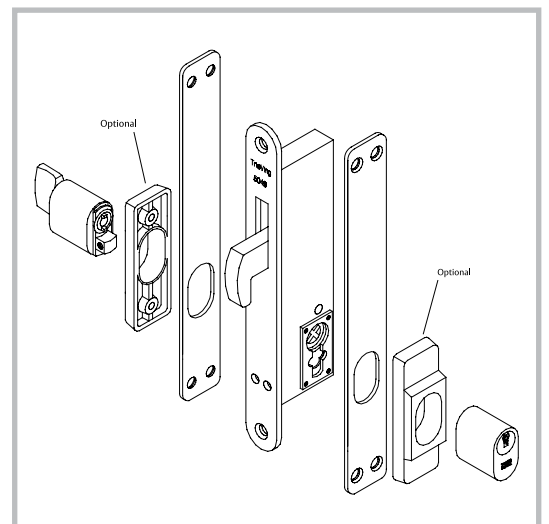

Lock case with available accessories